

# DLyte100i<sup>®</sup> series

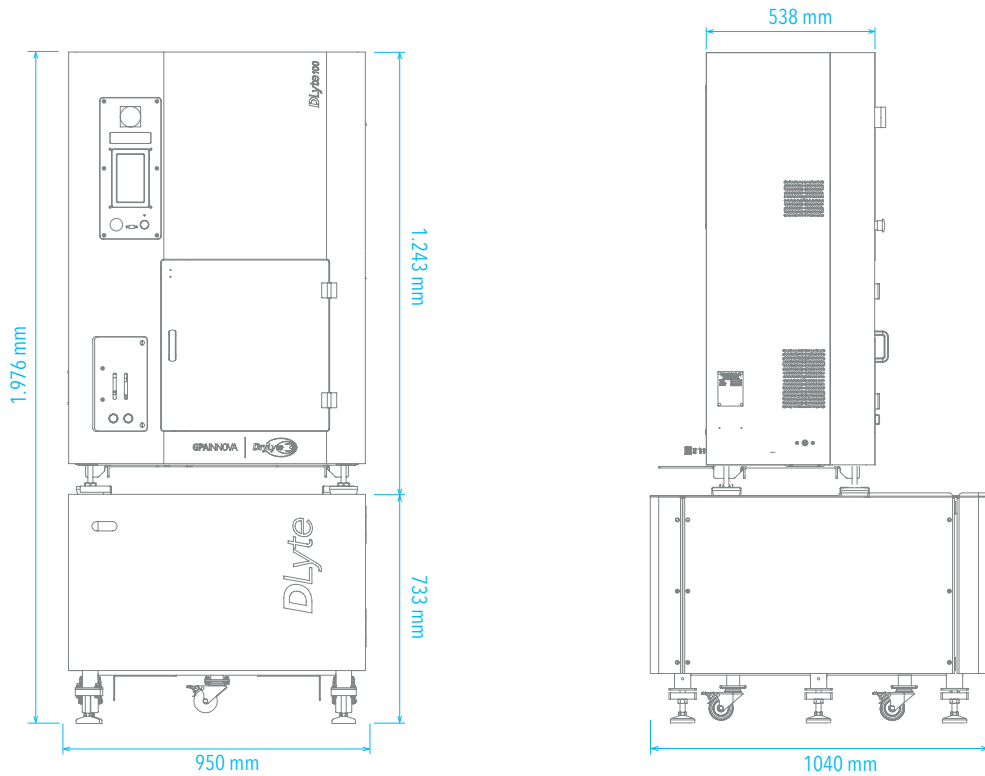

**DLyte100i<sup>®</sup>** series are the new patented machines for grinding and polishing Steel, Stainless-steel, Cobalt Chrome, Nickel, Titanium, Carbon Steel, Aluminium, Carbides and Precious Metals.

# DLyte100i<sup>®</sup> series



SERIES MODEL	MATERIALS	FREQUENCY
<b>DLyte100i</b>	For Steel, SS, CoCr, Nickel and Precious Metals	LF
<b>DLyte100iTi</b>	For Titanium	HF
<b>DLyte100i+Ti</b>	For Steel, SS, CoCr, Nickel, Titanium and Precious Metals	LF and HF
<b>DLyte100iCs</b>	For Carbon Steel	LF
<b>DLyte100i+Cs</b>	For Steel, SS, CoCr, Nickel, Precious Metals and Carbon Steel	LF
<b>DLyte100i Ti+Cs</b>	For Titanium and Carbon Steel	LF and HF
<b>DLyte100i +Ti+Cs</b>	For Steel, SS, CoCr, Nickel, Titanium, Precious Metals and Carbon Steel	LF and HF

## TECHNICAL SPECIFICATIONS

CAPACITY (PER CYCLE)	180 Ø x 80 mm (maximum volume centered to the axis)
MACHINE DIMENSIONS	950 x 730 x 1410 mm
SUPPORT DIMENSIONS	950 x 1040 x 700 mm
MACHINE WEIGHT	217,5 (247.5 kg Cs Series)
SUPPORT WEIGHT	100 kg
POWER	5 kW ☺ (single phase with industrial plug)
VOLTAGE	220-240 V
AIR PRESSURE	4-5 bar (air connector: 8mmØ or 1/4' BSP')

Consumption of 40 l/min. The air quality must be 1.5.1\* according to ISO 8573.  
 (\*) Air quality required for a maintenance every 6 months (change of filters).